



## Connecting with the Chinese Mainland

The Mainland is an important source of passenger and cargo growth for Hong Kong International Airport (HKIA), and presents enormous market potential to drive HKIA's future development. By capitalising on these opportunities, we will continue to contribute to Hong Kong's long-term competitiveness and its role as an international and regional aviation centre.



CO<sub>2</sub>-e↓

## Saving Energy at Zhuhai Airport



We work closely with our joint venture partner to improve Zhuhai Airport's environmental performance. In addition to instituting energy-saving measures that have proven effective at HKIA, we modified the layout of Zhuhai Airport's lighting fixtures. This maintained illumination standards and achieved an annual electricity saving of 182,000 kilowatt hours (kWh), the equivalent of 127 tonnes of greenhouse gas emission.

We installed 17 split-type air conditioners that allow us to maintain a comfortable environment for passengers during off-peak hours without using the terminal's main chiller plant. The operating cost for the air conditioners is about 10% of that of the chiller, saving some 205,000 kWh, or about 144 tonnes of greenhouse gas emission, annually. And we are installing film on the terminal's glass curtain wall to screen out ultraviolet light and reduce the need for air-conditioning.





During the year, work continued on the expansion of the domestic terminal at Hangzhou Xiaoshan International Airport, shown here in an artist's rendering.

### Zhuhai Airport

Since October 2006, Zhuhai Airport has been managed by a joint venture between the Zhuhai Municipal People's Government and the Airport Authority (AA).

Calendar 2009 saw further improvement at Zhuhai Airport. Passenger volume grew 24% from 2008, to 1.4 million. Cargo throughput increased 24%, to 13,800 tonnes, while air traffic movements fell 23%, to 23,347. The decline in air traffic movements was largely due to cutbacks in training flights caused by the economic downturn.

With the recent economic recovery, we expect that the number of training flights at Zhuhai Airport will increase. The Zhuhai Aviation Industry Park, a new industrial park focusing on general aviation-related manufacturing,

maintenance, repairs and logistics, will also have a positive impact on Zhuhai Airport's operations when manufacturing commences by the end of 2010.

### Hangzhou Xiaoshan International Airport

The AA acquired a 35% interest in Hangzhou Xiaoshan International Airport (HXIA) in December 2006. In calendar 2009, passenger volume at HXIA grew 18%, to 14.9 million, while cargo throughput increased 7.4%, to 226,307 tonnes. Air traffic movements rose 13% from 2008, to 134,058.

In 2009, work continued on the second phase of a RMB 7 billion expansion project at HXIA. A new 96,000-square-metre international passenger terminal is scheduled to open in mid-2010. Expansion of the

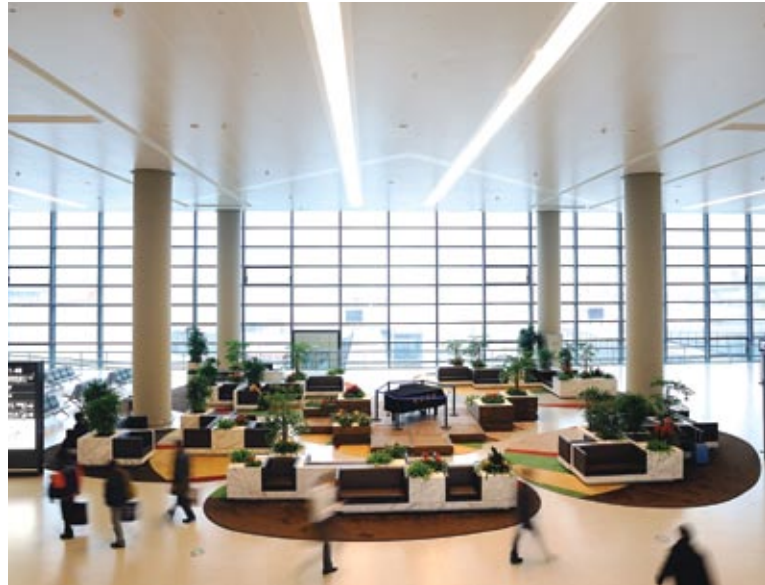

The Airport Authority's new joint venture with Shanghai Airport (Group) Co., Ltd, operates several facilities at Shanghai Hongqiao International Airport.

domestic terminal and construction of a second runway and related airfield facilities are now under way and expected to be completed by early 2012. Feasibility studies on new supporting infrastructure, including a multi-storey car park, cargo terminal and transportation centre, are in progress.

### Shanghai Hongqiao International Airport

In October 2009, the AA signed an agreement with Shanghai Airport (Group) Co., Ltd. to establish a joint venture, the Shanghai Hong Kong Airport Management

Co., Ltd. The new company manages Shanghai Hongqiao International Airport's two terminals, east transportation centre and retail operations.

Since October 2009, AA staff have assisted in the commissioning of Hongqiao airport's new facilities, including the new Terminal 2 and the east transportation centre. We have also shared with Hongqiao airport's staff our experience in terminal operations, retail and commercial management, and ambience enhancement.

